

What's New in HRS? Biomarkers and Genetics

David Weir and Eileen M. Crimmins



Newer Biological and Performance Data – 2006, 2008, 2010

- **Provide information about the biological mechanisms or paths**
- **Provide information about earlier processes than disease or death**
- **Provide information about progression of disease**
- **Provide information respondent does not know**
- **Use same scale for everyone**

Saliva Collection Device



Lancet for cutting finger for DBS

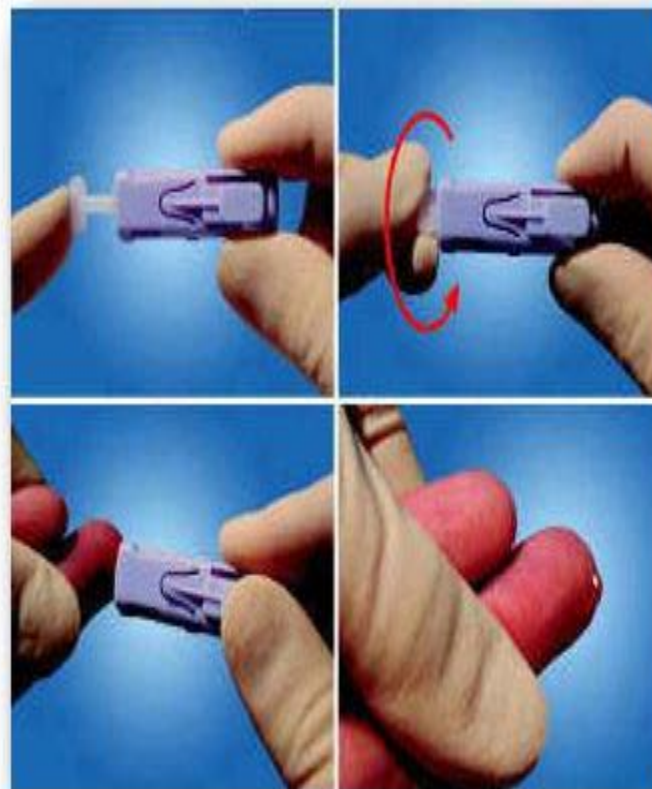

Biomarkers/Physical Measures

- Total and HDL cholesterol
- Glycated hemoglobin
- CRP
- Cystatin- C
- DNA
- Blood Pressure and Pulse
- Height/weight/waist
- Grip strength*
- Peak flow*
- Timed walk/balance

*Also done in 1992
subsample

Multidisciplinary Model of Health Outcomes

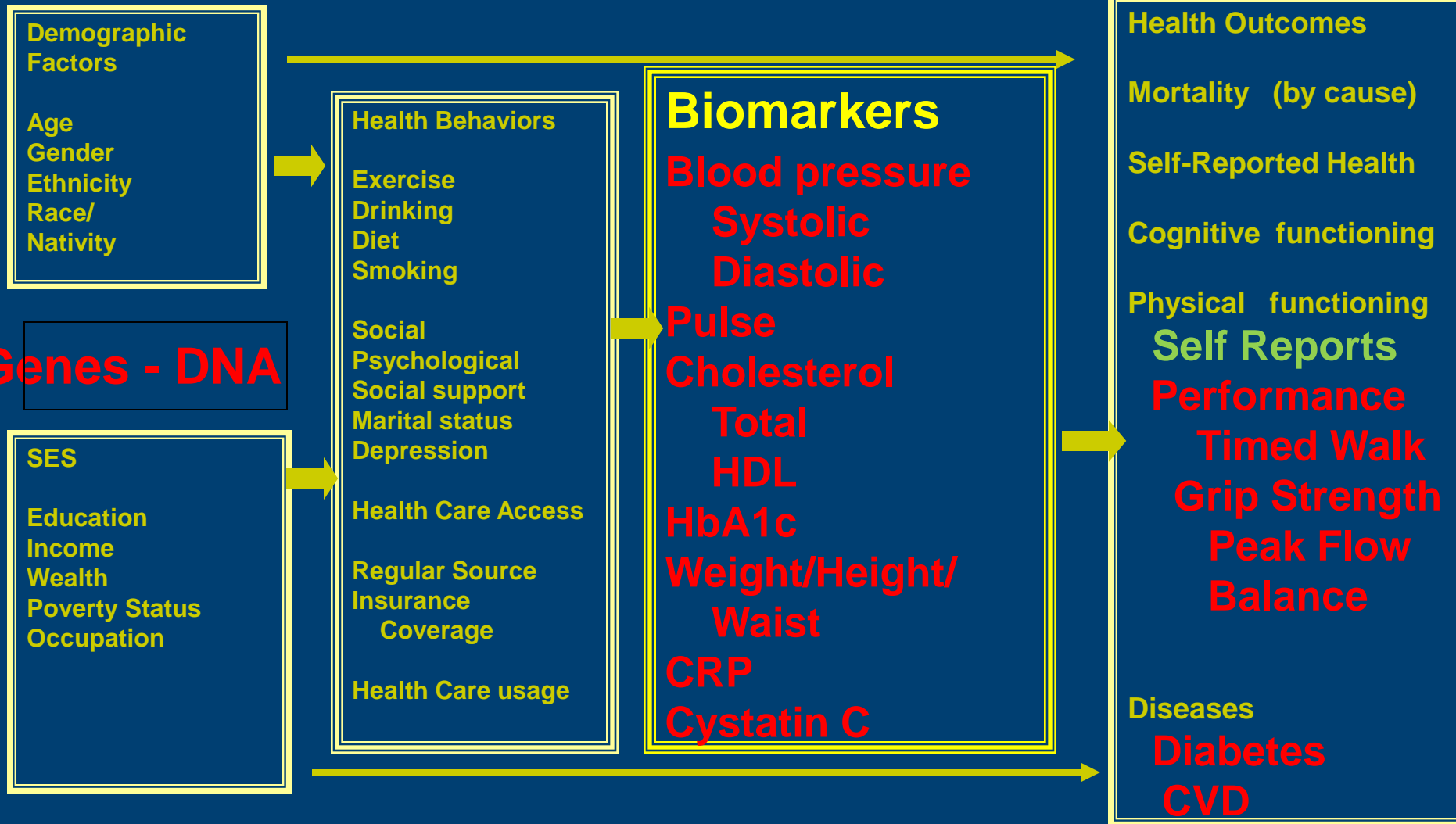

Validation Project

- USC/UCLA Center on Biodemography and Population Health
 - Dried Blood spots versus whole blood
 - Blood pressure meter
 - Blood Spot results for 2006 and 2008 will come out this month

%Hypertension in HRS 2006

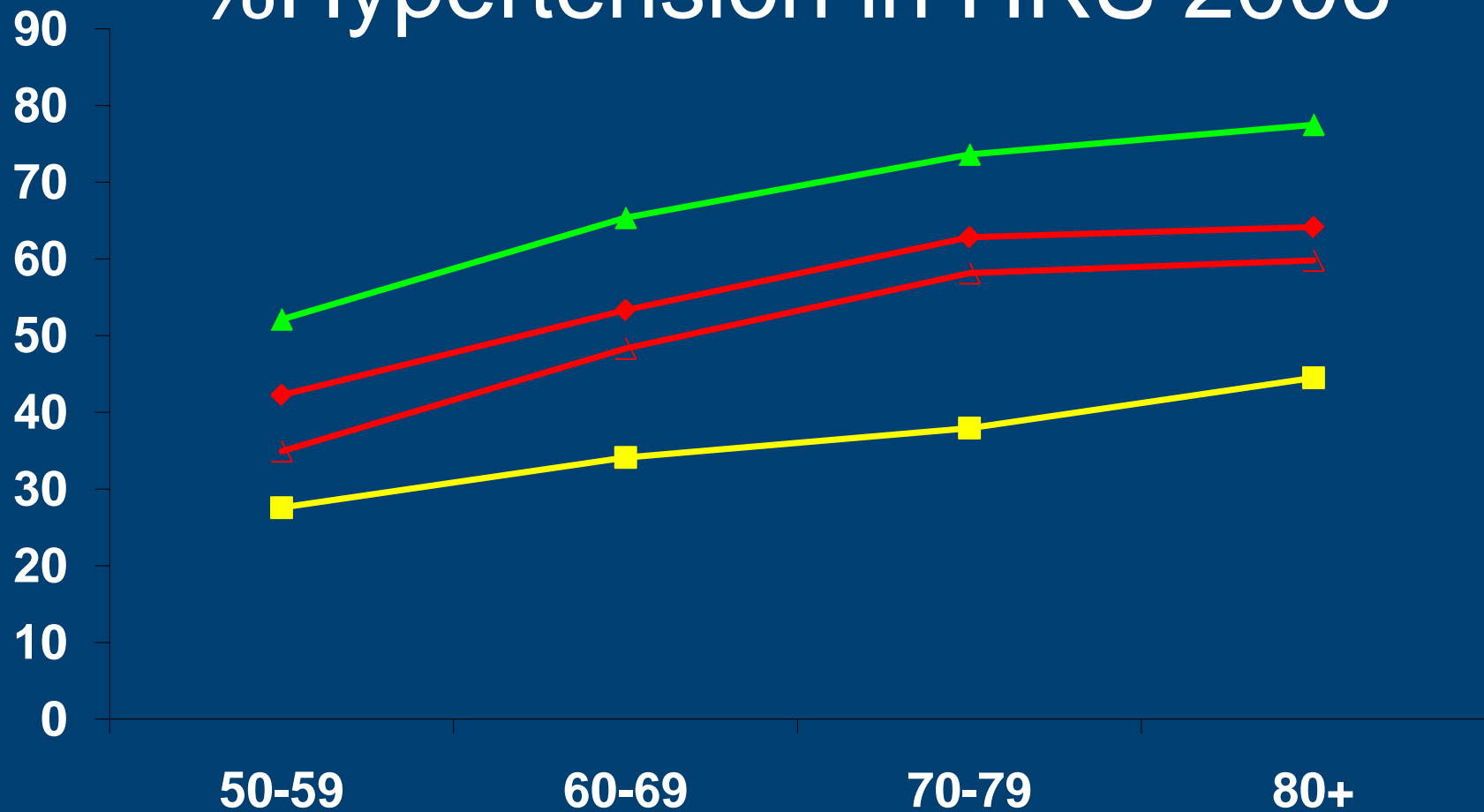

◆ Self-report

■ Measured

▲ Measured + Med

▾ Medication

%High Cholesterol in HRS 2006

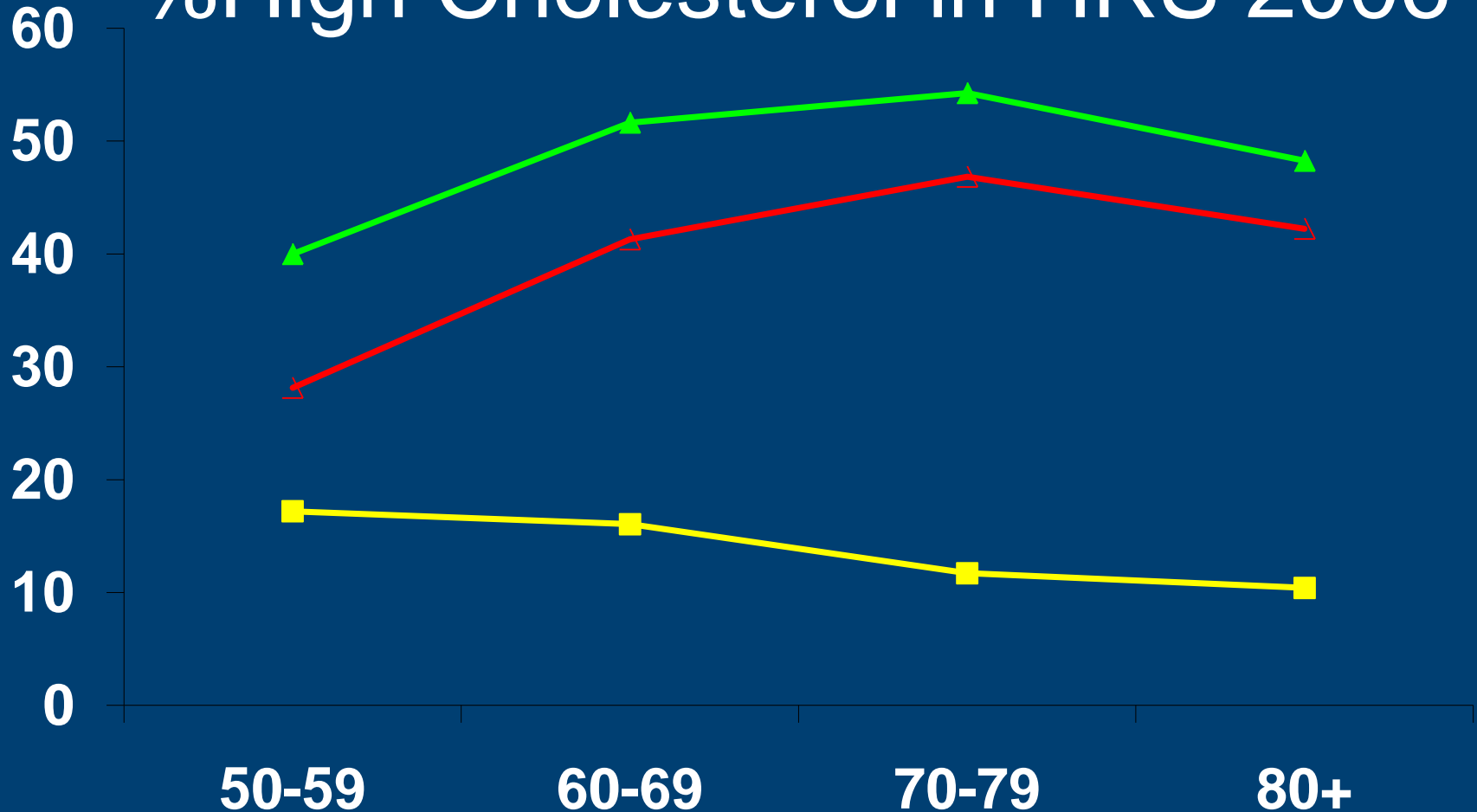

■ Measured

▲ Measured + Med

▾ Medication

%d Self Reported Diabetes or High (>6.4% glycated hemoglobin)

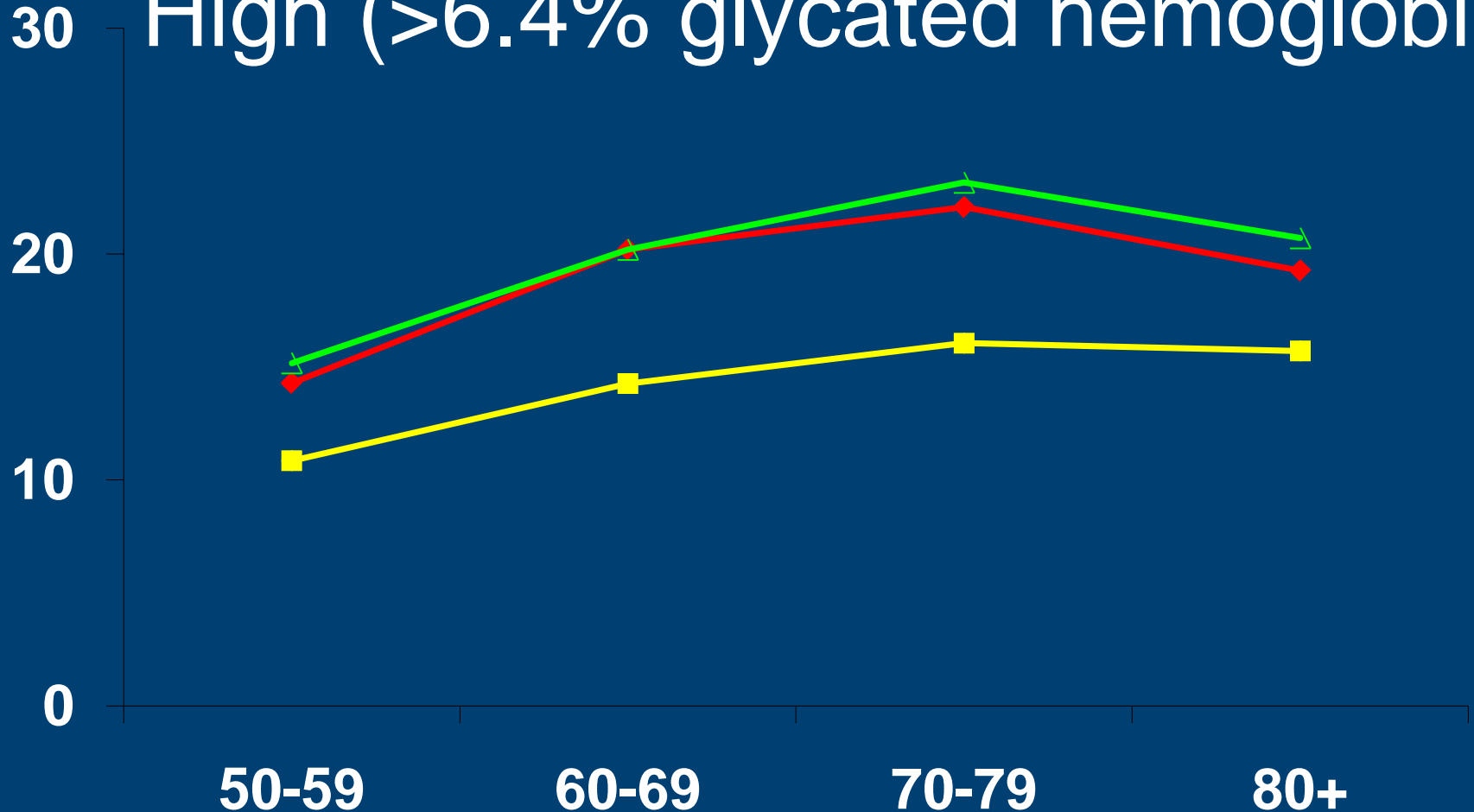

◆ HRS 06 Self-report ▲ HRS 06 Measured+Med ■ HRS 06 Measured

Racial and Ethnic Disparities in Hyperglycemia: Decomposition into Total Prevalence of Diabetes and Poor Management (HRS 2006)

Race/Ethnic Group	Percent at Biological Risk	Total Prevalence	Poor Management
African-Am	23.8%	34.4%	69.4%
Hispanic	24.9%	36.4%	68.4%
White	11.6%	19.9%	58.0%

Race/ethnic comparison	Disparity	Percent due to prevalence	Percent due to poor management
Black-white	12.3%	75.2%	24.8%
Hispanic-white	13.3%	78.5%	21.5%

Racial and Ethnic Disparities in High Blood Pressure: Decomposition into Total Prevalence of Hypertension and Poor Management (HRS 2006)

	Percent at Biological Risk	Total Prevalence	Poor Management
African-Am	44.6%	82.2%	54.2%
Hispanic	36.0%	64.2%	56.1%
White	33.0%	63.7%	51.8%
Race/ethnic comparison	Disparity	Percent due to prevalence	Percent due to poor management
Black-white	11.5%	85.3%	14.7%
Hispanic-white	3.0%	9.2%	90.8%

Genetics in HRS

- GWAS approach led by HRS itself preferred over ELSA model of letting researchers access DNA to do their own genotyping

SAMPLE

- 13,000 samples in repository from 2006 and 2008 waves
- 7,000 additional samples collected in 2010 and 2012, including large new oversample of minorities
- Total target of 20,000 individuals

CHIP

- HRS is using 2.5m SNP chip by Illumina
 - Much better coverage of genetic variation in African-origin populations than earlier chips
 - Covers all SNPs with at least 5% frequency of allelic variation in population

Timeline

- 2006 and 2008 samples are largely completed at CIDR
- 2010 samples to be delivered to CIDR probably mid-2011
- 2012 samples early 2013

Data dissemination

- We want to encourage use and protect confidentiality
- Deposition in dbGap is required
 - dbGap primary point of distribution of genotype data
 - Limited phenotype data
- HRS holds key to linking dbGap ID numbers to HRS public ID numbers
- Restricted data agreement needed to obtain key to link to public data

Thank you